

# KR 60-2 JET



	KR 60-2 JET	KR 60 L45-2 JET	KR 60 L30-2 JET
Max. reach	2,002 mm	2,202 mm	2,402 mm
Rated payload	60 kg	45 kg	30 kg
Rated suppl. load, arm/link arm/rot. column	35 kg/-/-	35 kg/-/-	35 kg/-/-
Rated total load	95 kg	80 kg	65 kg
Pose repeatability	±0.15 mm	±0.15 mm	±0.15 mm
Number of axes	6	6	6
Mounting position	wall, ceiling	wall, ceiling	wall, ceiling
Robot footprint	-	-	-
Weight	435 kg	471 kg	479 kg



Axis data/ Range of motion	Speed with rated payload 60 kg	Speed with rated payload 45 kg	Speed with rated payload 30 kg
Axis 1 (A1)	1.5 to 30 m	3.1 m/s	3.1 m/s
Axis 2 (A2)	+0°/-180°	120°/s	120°/s
Axis 3 (A3)	+158°/-120°	166°/s	166°/s
Axis 4 (A4)	+/-350°	260°/s	260°/s
Axis 5 (A5)	+/-119°	245°/s	245°/s
Axis 6 (A6)	+/-350°	322°/s	322°/s

## Controller **Operating conditions**

KR C4 Ambient temperature +10 °C to +55 °C

## Teach pendant **Protection rating**

KUKA smartPAD Protection rating, robot IP 64  
Protection rating, in-line wrist IP 65

Work envelope <sup>1)2)</sup>	Dimensions A	Dimensions B	Dimensions C	Dimensions D	Dimensions E	Dimensions F	Dimensions G	Volume
KR 60-2 JET	2,002 mm	2,516 mm	1,845 mm	1,218 mm	627 mm	1,520 mm	820 mm	5.7 m <sup>3</sup>
KR 60 L45-2 JET	2,202 mm	2,916 mm	2,045 mm	1,363 mm	682 mm	1,720 mm	1,020 mm	7.2 m <sup>3</sup>
KR 60 L30-2 JET	2,402 mm	3,316 mm	2,245 mm	1,446 mm	799 mm	1,920 mm	1,220 mm	9.0 m <sup>3</sup>

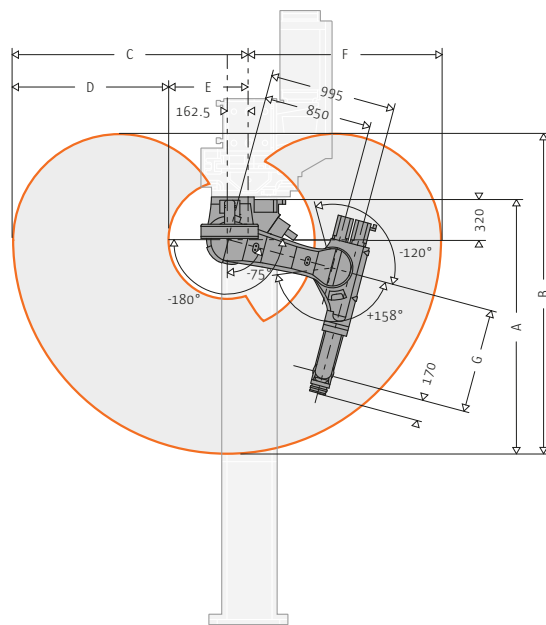
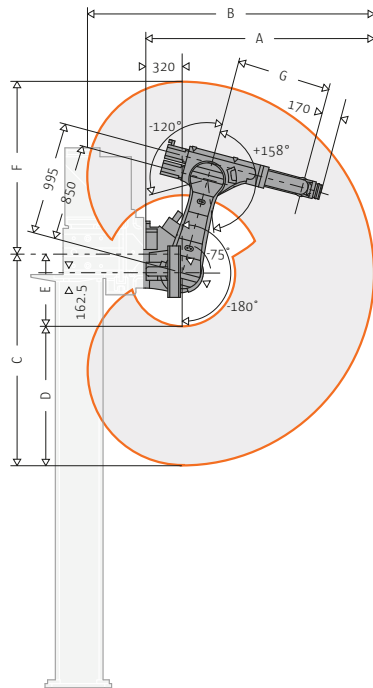

**KUKA Roboter GmbH**  
Hery Park 3000, 86368 Gersthofen, Germany. Phone: +49 821 4533-0, www.kuka-robotics.com

Details provided about the properties and usability of the products are purely for information purposes and do not constitute a guarantee of these characteristics. The extent of goods delivered and services performed is determined by the subject matter of the specific contract. No liability accepted for errors or omissions.

<sup>1)</sup> Relative to intersection of axes 4/5.  
<sup>2)</sup> Portal: Illustration similar